

# Getting started

Home / Getting started / Turning the DxO ONE on and off



## Turning the DxO ONE on and off

Getting started

To switch the DxO ONE on, slide the protective lens cover down.

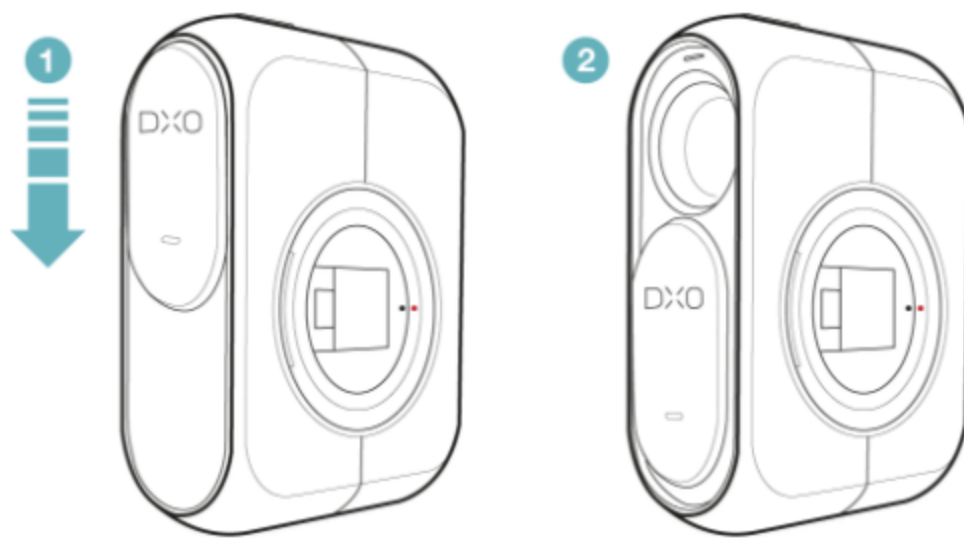

To turn the DxO ONE off, slide the cover over the lens.

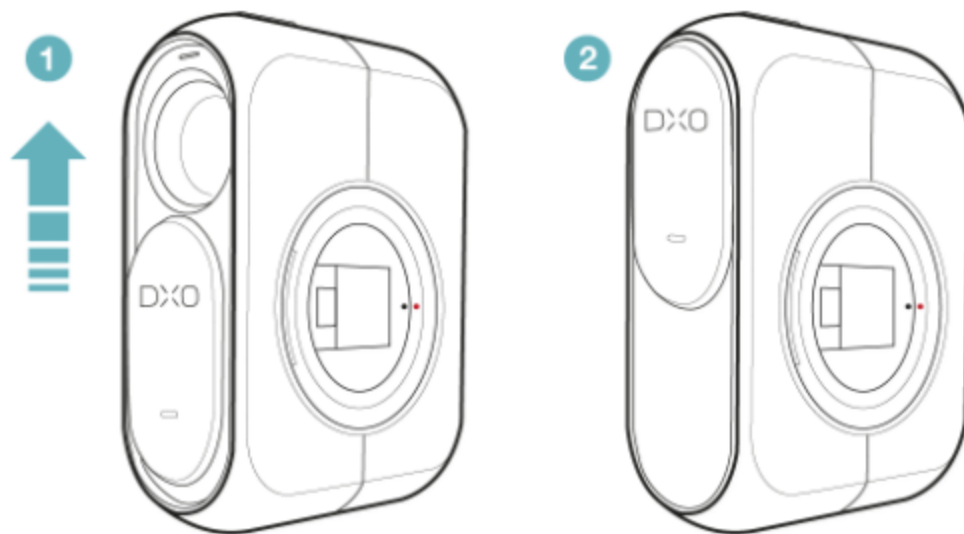

### LANGUAGES

- Français
- Deutsch
- Español
- 日本語

### RELATED POSTS

No related post

< CHECKING THE BATTERY LEVEL AND CHARGING

CONNECTING THE DXO ONE TO THE IPHONE AND DOWNLOADING THE APPLICATION >

Receive our newsletter

SUBSCRIBE

Follow us



Choose your language



#### DxO ONE

- Overview
- Image quality
- iOS App
- Design
- Press & Testimonials
- Find a retailer

#### PHOTO SOFTWARE

- DxO PhotoLab
- DxO FilmPack
- DxO ViewPoint

#### PRESS & TESTIMONIALS

- DxO ONE Camera
- Photo Software

#### LEARN AND SUPPORT

- Product How-To's
- Support
- Forum
- Software Registration

#### COMPANY

- About
- Careers
- Press
- Contact

#### SHOP

- DxO ONE Camera & Accessories
- Photo Software
- Find a Retailer
- My Account

#### VISIT OUR

PARTNER SITES :

DxOMark ↗

Imaging Quality ↗